

# The EZ Witness Evangelism System



The tool that makes witnessing for Christ easy, fun, and effective.



- Pray before using.
  - Carry it in your pocket (but keep it away from cards with magnetic strips, i.e. room keys, credit cards, etc.)
  - Put it on your refrigerator when not in use as a reminder of the great commission, Matthew 28:16-20
  - Play with it on mass transit systems in view of the public.
  - Put it in plain sight.
  - Give it away.
  - Take it on mission trips.
  - Always be prepared to give a reason for the hope you have in Christ! 1 Peter 3:15
  - Have fun with and enjoy the tool.
  - Avoid putting the tool in close proximity of pacemakers, hard drives, or other devices that may be affected by magnets.
- To order more EZ Witness tools, go to [www.ezwitness.biz](http://www.ezwitness.biz) or call Steve at (574) 398-9766

Patent Pending

# The EZ Witness Evangelism System



The tool that makes witnessing for Christ easy, fun, and effective.



- Pray before using.
  - Carry it in your pocket (but keep it away from cards with magnetic strips, i.e. room keys, credit cards, etc.)
  - Put it on your refrigerator when not in use as a reminder of the great commission, Matthew 28:16-20
  - Play with it on mass transit systems in view of the public.
  - Put it in plain sight.
  - Give it away.
  - Take it on mission trips.
  - Always be prepared to give a reason for the hope you have in Christ! 1 Peter 3:15
  - Have fun with and enjoy the tool.
  - Avoid putting the tool in close proximity of pacemakers, hard drives, or other devices that may be affected by magnets.
- To order more EZ Witness tools, go to [www.ezwitness.biz](http://www.ezwitness.biz) or call Steve at (574) 398-9766

Patent Pending

1. Start the presentation with the sliding component in the position that the black surface is visible in its open area.

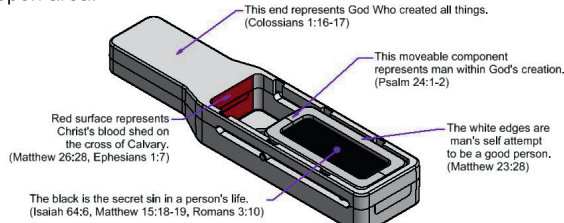

2. Push the sliding component toward the solid end of the main body.

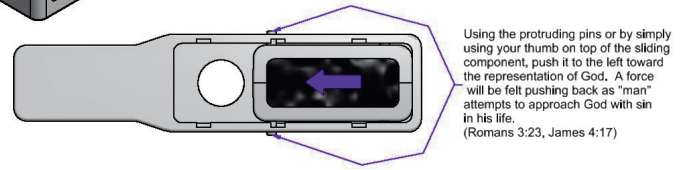

3. Point out and explain the resistance encountered and the gap that cannot be closed when the slider is pushed as far as it will go.

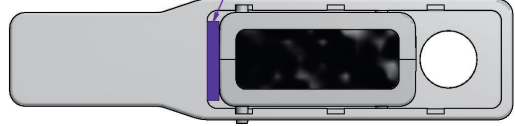

4. Let go of the sliding component and reveal that it moves away from the solid portion of the main body on its own.

5. Repeat the actions of steps two and four several times for emphasis. Optionally hand the tool to the audience and let him or her try it as well.

6. Push the sliding component to line up the short pins with the first pair of grooves in the main body.

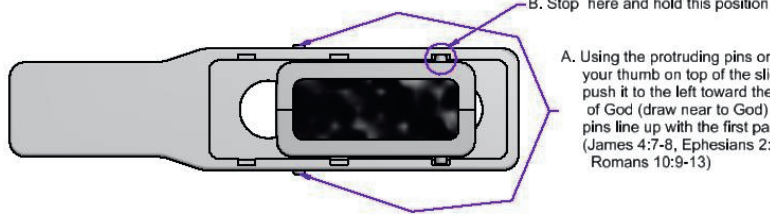

1. Start the presentation with the sliding component in the position that the black surface is visible in its open area.

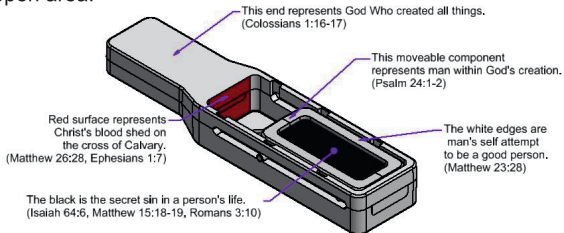

2. Push the sliding component toward the solid end of the main body.

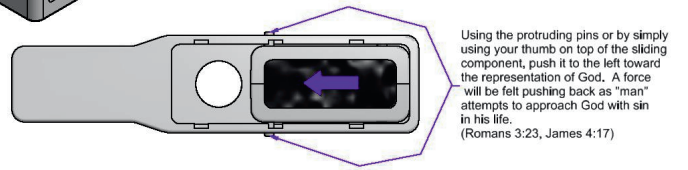

3. Point out and explain the resistance encountered and the gap that cannot be closed when the slider is pushed as far as it will go.

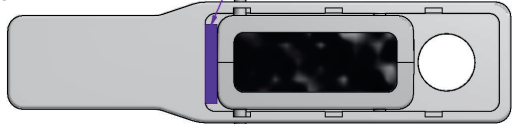

4. Let go of the sliding component and reveal that it moves away from the solid portion of the main body on its own.

5. Repeat the actions of steps two and four several times for emphasis. Optionally hand the tool to the audience and let him or her try it as well.

6. Push the sliding component to line up the short pins with the first pair of grooves in the main body.

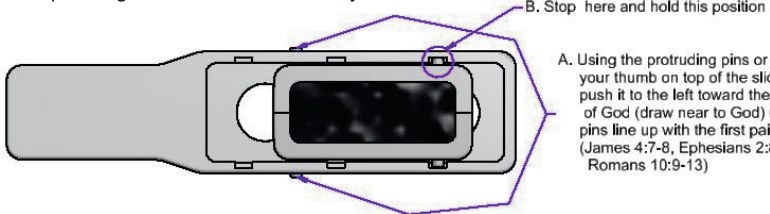

7. Press down on the end of sliding component where the long pins are to release the opposite end from the track. Alternately, push up on the sliding component at the end where the short pins are located by inserting a finger through the bottom hole.

A. Press down on this edge to pivot slider out of the track.

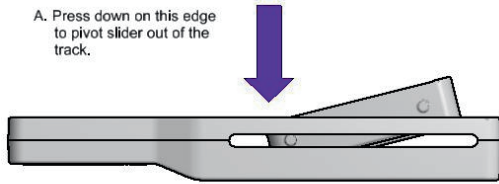

B. Alternately insert a fingertip into the hole on the bottom to push this end of the sliding component up out of the track.



10. Hold the sliding component in place once it is back in its track using the two long pins protruding out each side of the track while explaining the cross symbol and red end.

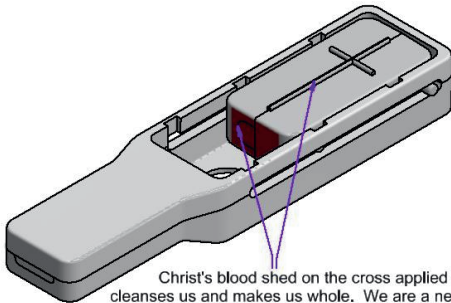

Christ's blood shed on the cross applied to our lives cleanses us and makes us whole. We are a new creation. (1 Tim 2:5, John 3:16, 2 Corinthians 5:17, Galatians 2:20, 1 Peter 2:24)

12. Press down on the right end of the sliding component in this position to flip it back over (or press up through the left hole in the bottom), line up the short pins with the right most pair of grooves and push it back into its track to reset the tool. Thank you for purchasing the EZ Witness Evangelism Tool. May you win many souls for Christ! God Bless!

8. Push the released, pivoting sliding component away from the solid area of the main body.

Push the pivoting, sliding component to the right as it is being flipped over.

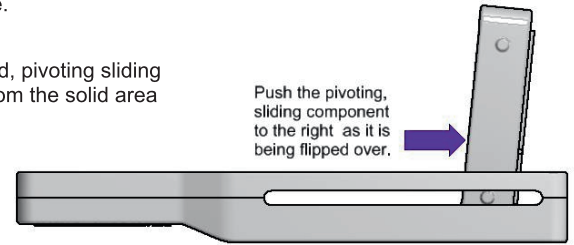

9. Continue pivoting the sliding component over as you line up the short pins with the middle pair of grooves to re-insert it back into the track.

Line up the short pins with the middle pair of grooves and push the sliding component back into its track.

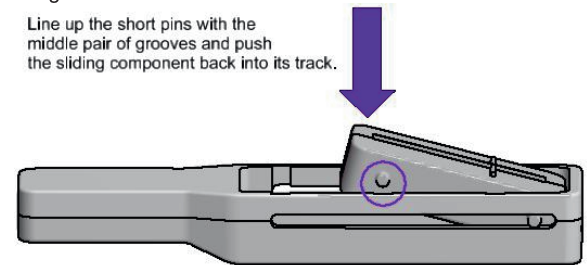

11. Release hold of the sliding component and it will snap to "God" on its own.

The previous sin barrier is gone and we are accepted by God and can have the relationship He desires as Father and child. (Romans 8:15-16, 1 John 3:1, 2 Corinthians 6:18)

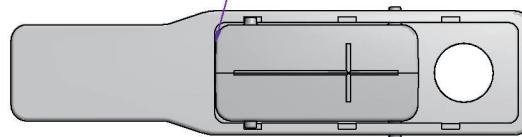

**Scan the QR Code with your smartphone or go to [www.ezwitness.biz](http://www.ezwitness.biz) for more detailed instructions**

7. Press down on the end of sliding component where the long pins are to release the opposite end from the track. Alternately, push up on the sliding component at the end where the short pins are located by inserting a finger through the bottom hole.

A. Press down on this edge to pivot slider out of the track.

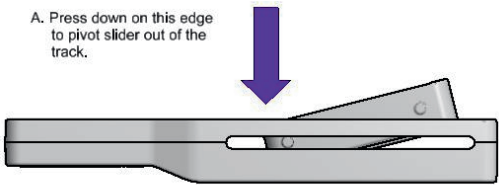

B. Alternately insert a fingertip into the hole on the bottom to push this end of the sliding component up out of the track.



10. Hold the sliding component in place once it is back in its track using the two long pins protruding out each side of the track while explaining the cross symbol and red end.

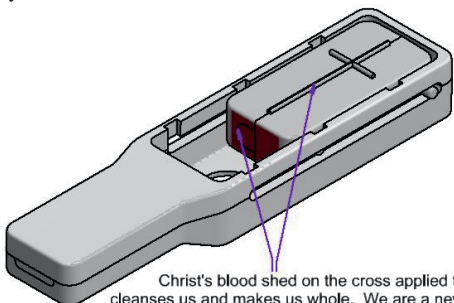

Christ's blood shed on the cross applied to our lives cleanses us and makes us whole. We are a new creation. (1 Tim 2:5, John 3:16, 2 Corinthians 5:17, Galatians 2:20, 1 Peter 2:24)

12. Press down on the right end of the sliding component in this position to flip it back over (or press up through the left hole in the bottom), line up the short pins with the right most pair of grooves and push it back into its track to reset the tool. Thank you for purchasing the EZ Witness Evangelism Tool. May you win many souls for Christ! God Bless!

8. Push the released, pivoting sliding component away from the solid area of the main body.

Push the pivoting, sliding component to the right as it is being flipped over.

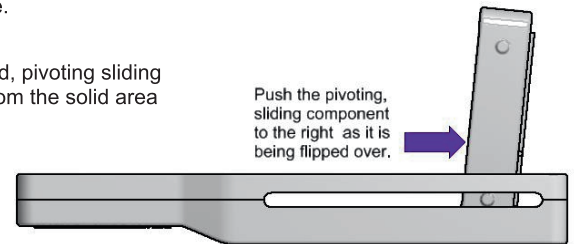

9. Continue pivoting the sliding component over as you line up the short pins with the middle pair of grooves to re-insert it back into the track.

Line up the short pins with the middle pair of grooves and push the sliding component back into its track.

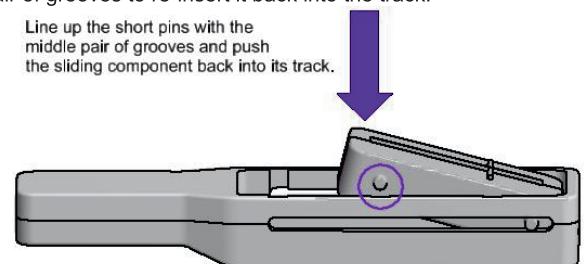

11. Release hold of the sliding component and it will snap to "God" on its own.

The previous sin barrier is gone and we are accepted by God and can have the relationship He desires as Father and child. (Romans 8:15-16, 1 John 3:1, 2 Corinthians 6:18)

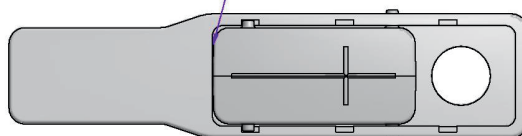

**Scan the QR Code with your smartphone or go to [www.ezwitness.biz](http://www.ezwitness.biz) for more detailed instructions**